

NPG2-1000Ah 2V1000Ah

Valve Regulated Lead Acid Battery



● Specifications

Nominal voltage	2V (2 cells per unit)	
Rated capacity (10HR)	1000Ah/1.8V	
Dimensions	Length	475±2mm (18.70inch)
	Width	175±2mm (6.89inch)
	Height	330±2mm (12.99inch)
	Total height	367±2mm (14.45inch)
Approx. weight	63.00kg (138.90 lbs)±3%	

● Outer dimensions (mm)

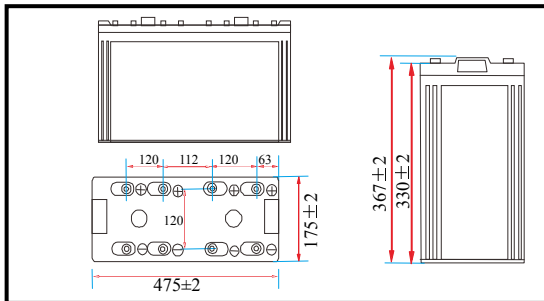

● Terminal type (mm)

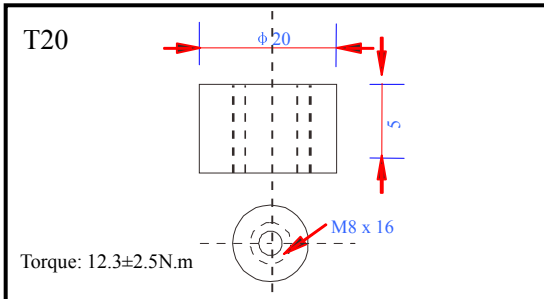

● Characteristics

Capacity (25°C)	10HR (1.80V)	1000Ah
	3HR (1.80V)	750Ah
	1HR (1.75V)	550Ah
Terminal type		T20
Internal resistance (Fully charged, 25°C)		Approx. 0.3mΩ
Capacity affected by temperature (10HR)	40°C	102%
	25°C	100%
	0°C	85%
	-15°C	65%
Self-discharge (25°C)	3 months	Remaining capacity: 91%
	6 months	Remaining capacity: 82%
	12 months	Remaining capacity: 65%
Nominal operating temperature		25°C±3°C (77°F±5°F)
Operating temperature range	Discharge	-15°C~50°C (5°F~122°F)
	Charge	-10°C~50°C (14°F~122°F)
	Storage	-20°C~50°C (-4°F~122°F)
Float charging voltage (25°C)		2.25 to 2.30V Temperature compensation: -3mV/°C/Block
Cyclic charging voltage (25°C)		2.40 to 2.45V Temperature compensation: -5mV/°C/Block
Maximum charging current		200A
Maximum discharge current		5500A (5 sec.)
Design life	18 years for floating (25°C)	
	Eurobat (20°C) >12 years, very long life.	

● Construction

Component	Positive plate	Negative plate	Container	Cover	Separator	Electrolyte	Safety valve	Terminal
Raw material	Lead dioxide	Lead	ABS	ABS	AGM	Gel	Rubber	Copper

● Constant current discharge characteristics unit: Ampere/Block (at 25°C, 77°F)

F.V/Time	15min	30min	60min	2h	3h	4h	5h	6h	8h	10h	20h
1.60V/cell	1250	870	600	360	261	206	171	151	120	102	53.4
1.65V/cell	1220	853	588	358	260	205	170	150	120	102	53.3
1.70V/cell	1175	827	570	355	258	203	169	149	119	101	53.2
1.75V/cell	1135	806	558	350	256	202	168	148	118	101	52.9
1.80V/cell	1075	777	540	341	251	196	163	144	114	100	52.5

● Constant power discharge characteristics unit: Watt/Block (at 25°C, 77°F)

F.V/Time	15min	30min	60min	2h	3h	4h	5h	6h	8h	10h	20h
1.60V/cell	2288	1627	1140	695	512	404	338	297	240	203	107
1.65V/cell	2233	1594	1117	691	509	401	336	296	238	202	107
1.70V/cell	2150	1546	1083	685	505	399	333	294	236	202	106
1.75V/cell	2077	1508	1060	675	502	396	331	292	235	200	106
1.80V/cell	1967	1453	1026	658	492	384	321	283	228	199	105

Note 1: Above characteristics data can be obtained within three charge and discharge cycles.

● Discharge characteristics (25°C)

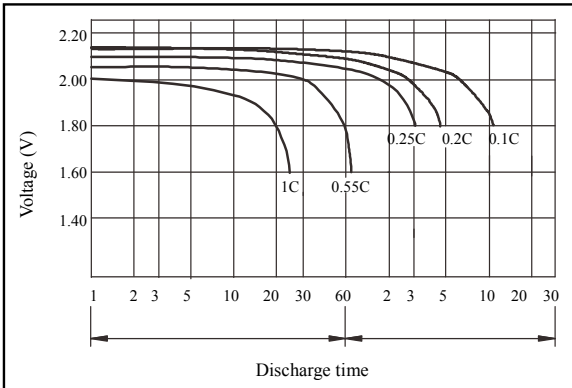

● Charging characteristics (25°C)

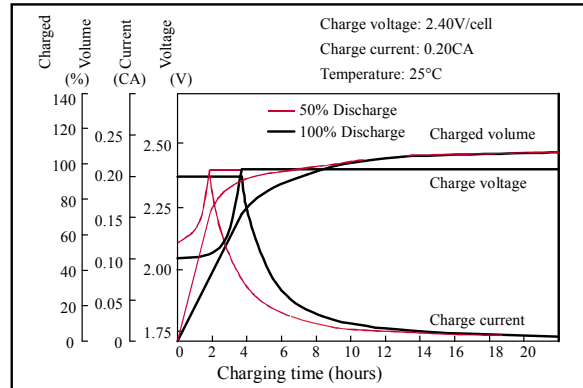

● Temperature effects on capacity

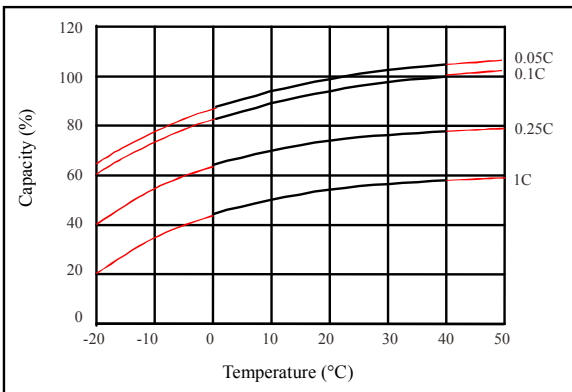

● Self-discharge characteristics

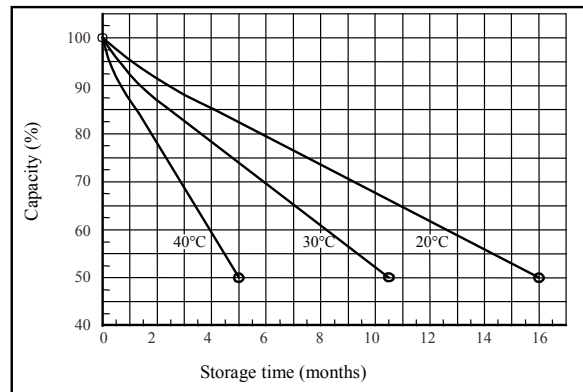

● Floating life on temperature

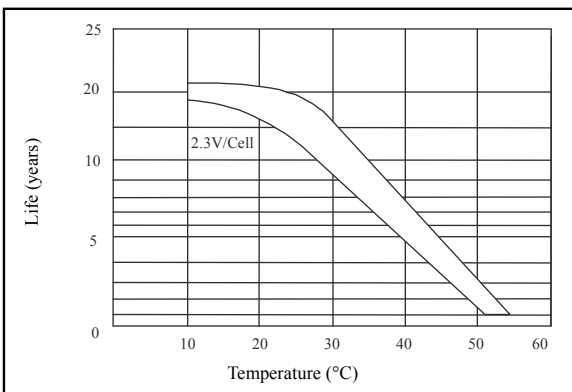

● Cycle life on D.O.D (25°C)

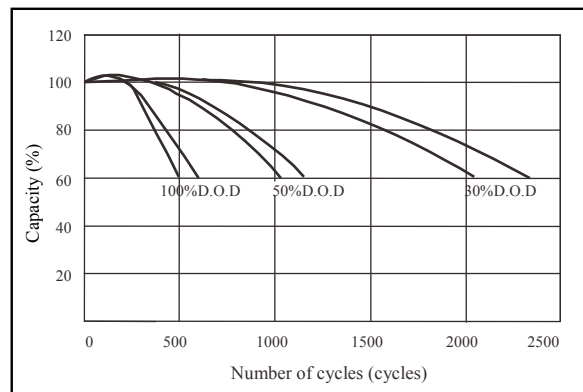

● Relationship for OCV and capacity (25°C)

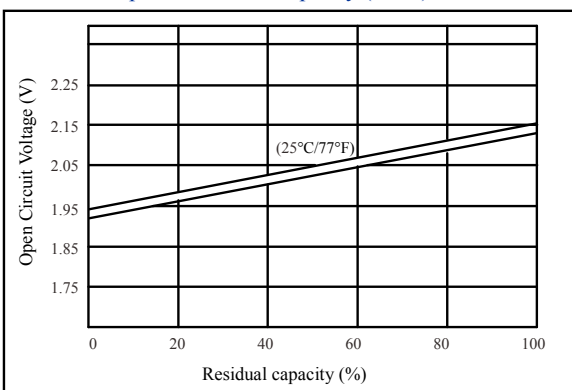

● Relationship for charging voltage and temperature

