

## NPD2-1500Ah 2V1500Ah

### Valve Regulated Lead Acid Battery



#### Specifications

Nominal voltage	2V (2 cells per unit)	
Rated capacity (10HR)	1500Ah/1.8V	
Dimensions	Length	400±2mm (15.75inch)
	Width	350±2mm (13.78inch)
	Height	345±2mm (13.58inch)
	Total height	382±2mm (15.04inch)
Approx. weight	96.50kg (212.70lbs)±3%	

#### Outer dimensions (mm)

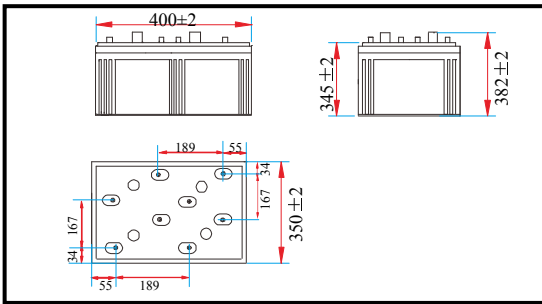

#### Terminal type (mm)

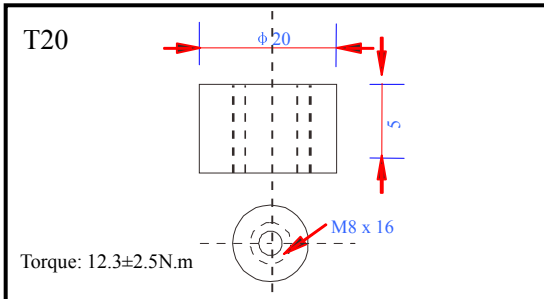

#### Characteristics

Capacity (25°C)	10HR (1.80V)	1500Ah
	3HR (1.80V)	1170Ah
	1HR (1.75V)	870Ah
Terminal type		T20
Internal resistance (Fully charged, 25°C)		Approx. 0.2mΩ
Capacity affected by temperature (10HR)	40°C	102%
	25°C	100%
	0°C	85%
	-15°C	65%
Self-discharge (25°C)	3 months	Remaining capacity: 91%
	6 months	Remaining capacity: 82%
	12 months	Remaining capacity: 65%
Nominal operating temperature		25°C±3°C (77°F±5°F)
Operating temperature range	Discharge	-15°C~50°C (5°F~122°F)
	Charge	-10°C~50°C (14°F~122°F)
	Storage	-20°C~50°C (-4°F~122°F)
Float charging voltage (25°C)		2.25 to 2.30V Temperature compensation: -3mV/°C/Block
Cyclic charging voltage (25°C)		2.40 to 2.50V Temperature compensation: -5mV/°C/Block
Maximum charging current		300A
Maximum discharge current		7500A (5 sec.)
Design life	15 years for floating (25°C)	
	Eurobat (20°C) : >12 years, very long life.	

#### Construction

Component	Positive plate	Negative plate	Container	Cover	Separator	Electrolyte	Safety valve	Terminal
Raw material	Lead dioxide	Lead	ABS	ABS	AGM	Sulfuric acid	Rubber	Copper

#### Constant current discharge characteristics unit: Ampere/Block (at 25°C, 77°F)

F.V/Time	30min	60min	2h	3h	4h	5h	6h	8h	10h	20h	24h
1.60V/cell	1420	983	575	414	331	285	245	193	160	84.2	72.1
1.65V/cell	1391	953	571	411	329	283	244	192	159	84.0	72.0
1.70V/cell	1349	924	566	408	327	281	242	191	159	83.8	71.7
1.75V/cell	1316	894	558	406	324	279	240	190	158	83.3	71.3
1.80V/cell	1268	865	544	393	315	271	233	184	157	82.7	70.8

#### Constant power discharge characteristics unit: Watt/Block (at 25°C, 77°F)

F.V/Time	30min	60min	2h	3h	4h	5h	6h	8h	10h	20h	24h
1.60V/cell	2655	1867	1109	811	649	561	483	385	318	168	145
1.65V/cell	2602	1811	1103	806	645	558	480	382	317	168	145
1.70V/cell	2522	1755	1093	801	640	554	477	380	316	168	144
1.75V/cell	2461	1699	1077	795	636	550	473	377	314	167	143
1.80V/cell	2371	1643	1049	771	617	534	459	366	312	165	142

Note 1: Above characteristics data can be obtained within three charge and discharge cycles.

### ● Discharge characteristics (25°C)

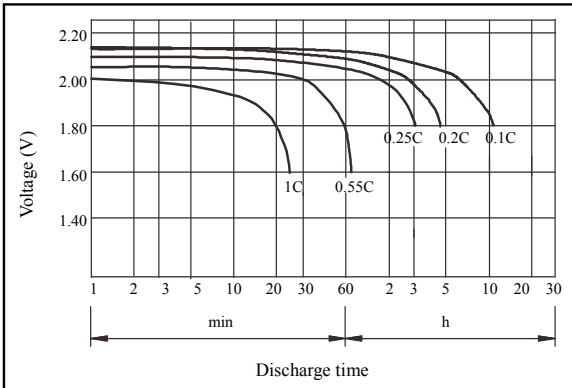

### ● Charging characteristics (25°C)

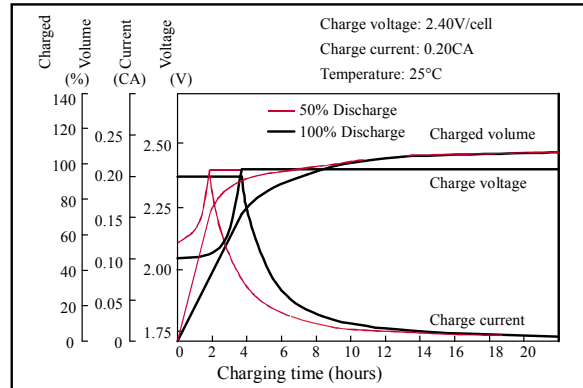

### ● Temperature effects on capacity

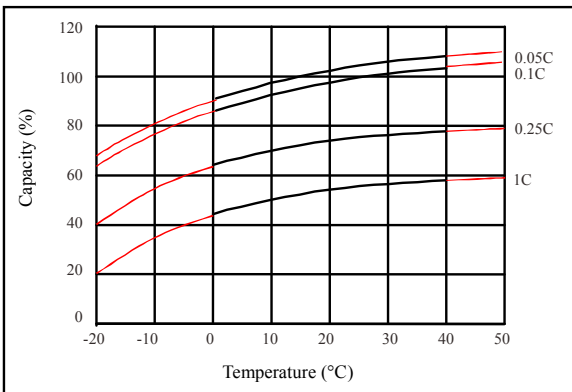

### ● Self-discharge characteristics

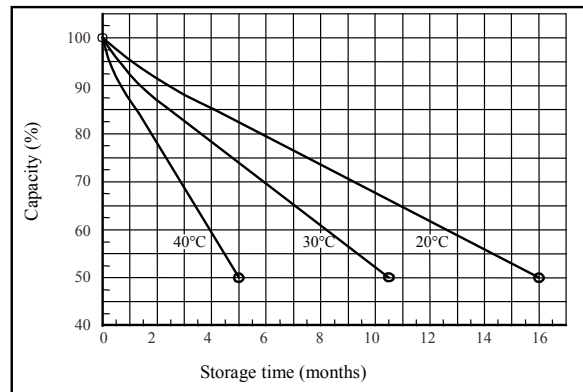

### ● Floating life on temperature

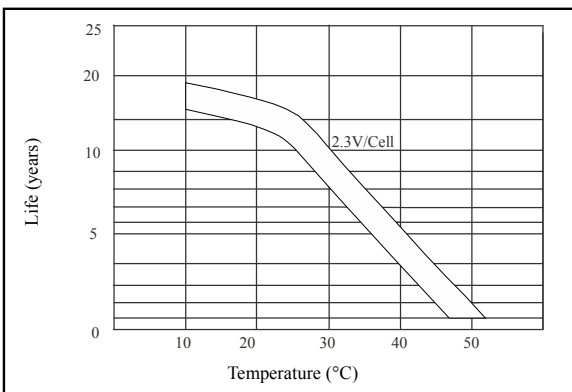

### ● Cycle life on D.O.D (25°C)

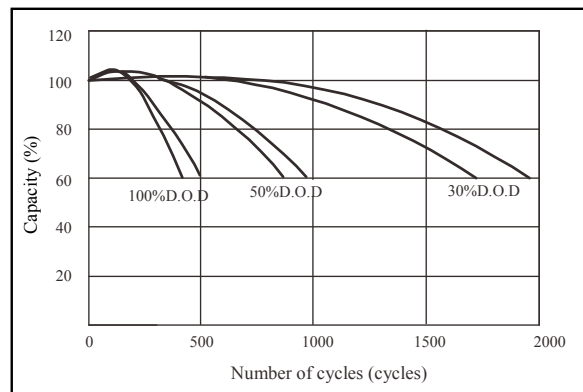

### ● Relationship for OCV and capacity (25°C)

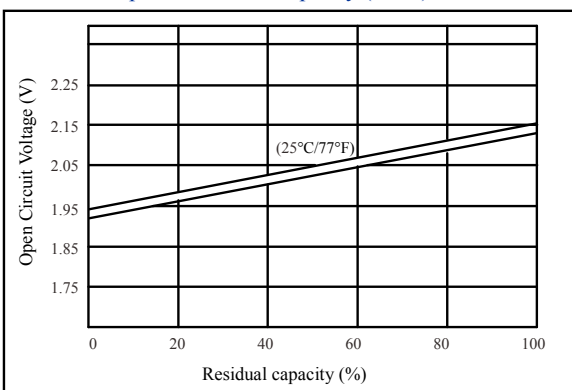

### ● Relationship for charging voltage and temperature

