

HR1276W (12V76 Watts/cell)

Valve Regulated Lead Acid Battery



● Specifications

Nominal voltage	12V (6 cells per unit)	
Rated capacity (15min. rate)	76 Watts/cell /1.67V	
Dimensions	Length	181±2mm (7.13inch)
	Width	77±1mm (3.03inch)
	Height	167±2mm (6.57inch)
	Total height	167±2mm (6.57inch)
Approx. weight	5.70kg (12.60lbs)±3%	

● Outer dimensions (mm)

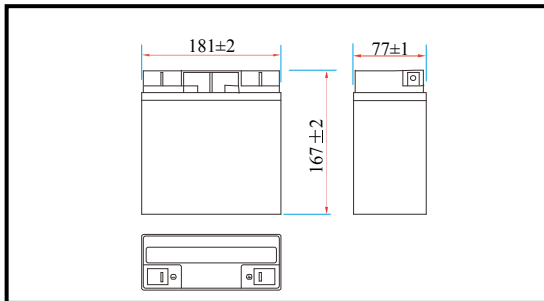

● Terminal type (mm)

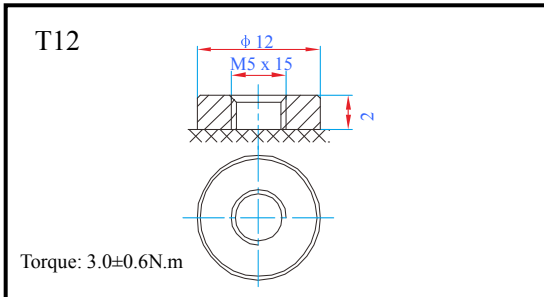

● Characteristics

Capacity (25°C)	15min. rate	76 Watts/cell /1.67V
	20HR	18Ah/10.5V
Terminal type		T12
Internal resistance (Fully charged, 25°C)		Approx. 12mΩ
Capacity affected by temperature (10HR)	40°C	102%
	25°C	100%
	0°C	85%
	-15°C	65%
Self-discharge (25°C)	3 months	Remaining capacity: 91%
	6 months	Remaining capacity: 82%
	12 months	Remaining capacity: 65%
Nominal operating temperature		25°C±3°C (77°F±5°F)
Operating temperature range	Discharge	-15°C~50°C (5°F ~ 122°F)
	Charge	-10°C~50°C (14°F ~ 122°F)
	Storage	-20°C~50°C (-4°F ~ 122°F)
Float charging voltage (25°C)		13.60 to 13.80V Temperature compensation: -18mV/°C/Block
Cyclic charging voltage (25°C)		14.50 to 15.00V Temperature compensation: -30mV/°C/Block
Maximum charging current		6.08A
Maximum discharge current		270A (5 sec.)
Design life	5 years for floating (25°C)	
	Eurobat (20°C): 3-5 years, standard commercial	

● Construction

Component	Positive plate	Negative plate	Container	Cover	Separator	Electrolyte	Safety valve	Terminal
Raw material	Lead dioxide	Lead	ABS	ABS	AGM	Sulfuric acid	Rubber	Copper

● Constant current discharge characteristics unit: Ampere/cell (at 25°C, 77°F)

F.V/Time	5min	10min	15min	20min	30min	45min	60min	2h	3h	4h	5h
1.60V/cell	86.73	53.45	40.00	31.60	21.40	15.90	13.00	7.35	5.22	4.20	3.61
1.67V/cell	82.85	51.03	38.60	30.40	20.70	15.40	12.70	7.28	5.18	4.17	3.58
1.70V/cell	80.64	49.67	37.60	29.70	20.40	15.10	12.50	7.24	5.16	4.15	3.56
1.75V/cell	77.18	47.57	36.30	28.70	19.90	14.70	12.20	7.13	5.12	4.12	3.54
1.80V/cell	72.87	44.84	34.40	27.20	19.10	14.20	11.80	6.95	4.97	4.00	3.43

● Constant power discharge characteristics unit: Watt/cell (at 25°C, 77°F)

F.V/Time	5min	10min	15min	20min	30min	45min	60min	2h	3h	4h	5h
1.60V/cell	162.98	98.70	79.10	62.60	42.40	31.40	25.70	14.60	10.50	8.45	7.26
1.67V/cell	154.78	94.30	76.40	60.10	41.10	30.40	25.10	14.50	10.40	8.37	7.19
1.70V/cell	151.70	91.80	74.40	58.90	40.30	29.80	24.70	14.40	10.40	8.34	7.17
1.75V/cell	144.53	87.90	71.80	56.80	39.30	29.10	24.20	14.20	10.30	8.28	7.12
1.80V/cell	136.33	82.90	68.10	53.80	37.90	28.00	23.40	13.80	9.98	8.03	6.90

Note 1: Above characteristics data can be obtained within three charge and discharge cycles.

● Discharge characteristics (25°C)

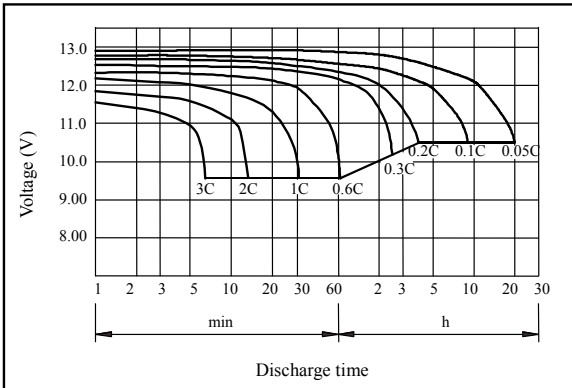

● Charging characteristics (25°C)

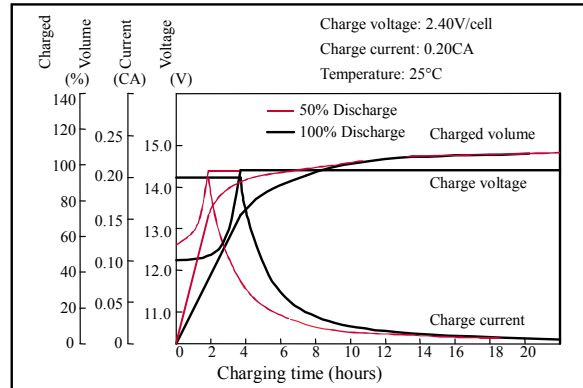

● Temperature effects on capacity

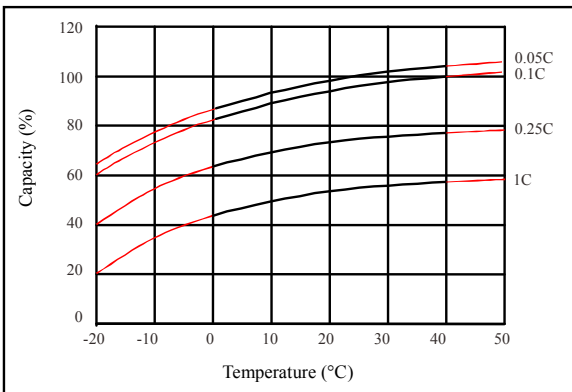

● Self-discharge characteristics

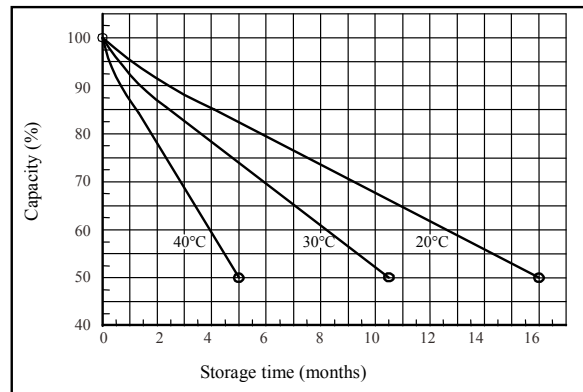

● Floating life on temperature

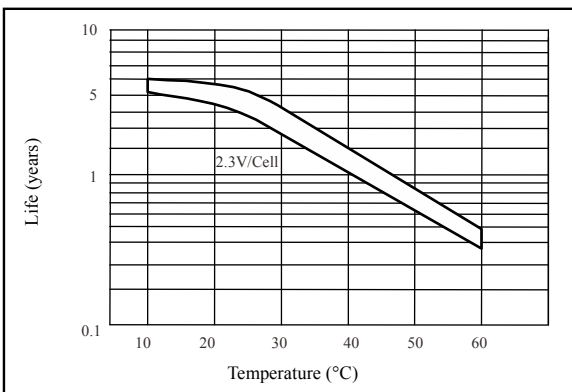

● Cycle life on D.O.D (25°C)

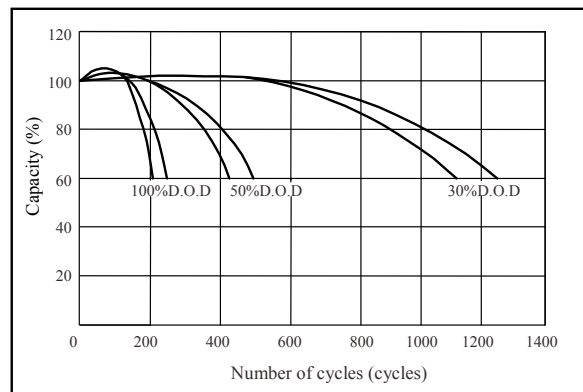

● Relationship for OCV and capacity (25°C)

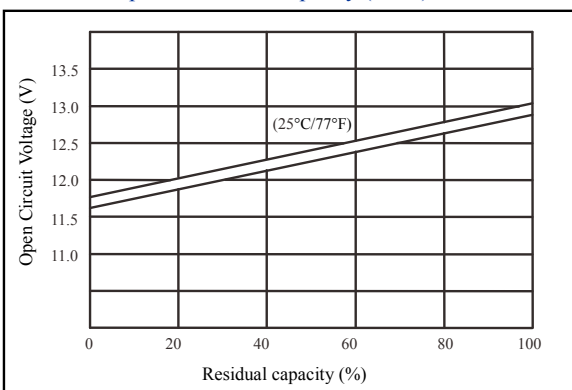

● Relationship for charging voltage and temperature

